

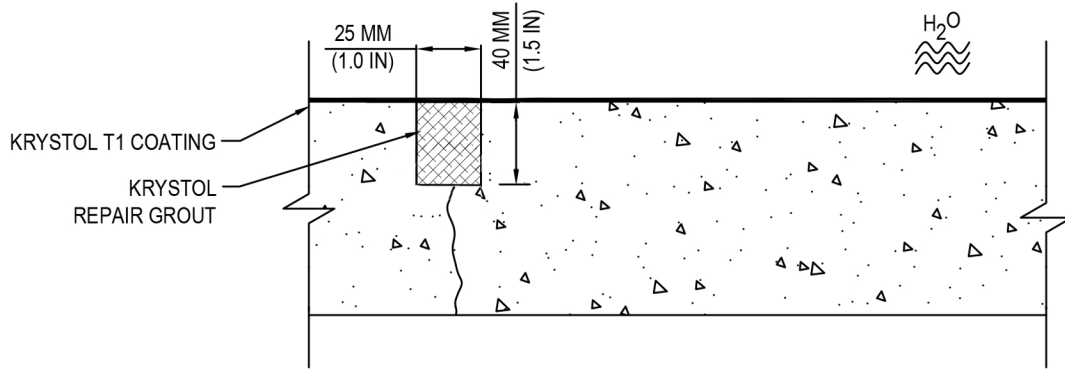

KRYTON INTERNATIONAL INC.
 1645 EAST KENT AVE.
 VANCOUVER, BC V5P 2S8
 TOLL FREE: 1-800-267-8280
 PHONE: (604) 324-8280
 FAX: (604) 324-8899
 www.kryton.com

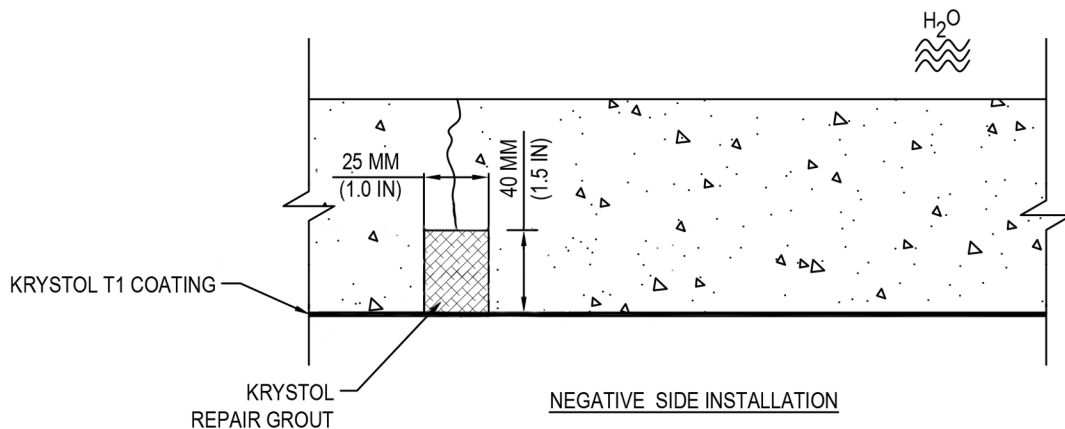

POSITIVE SIDE INSTALLATION



NEGATIVE SIDE INSTALLATION

MANUFACTURER'S NOTES:

1. SAW CUT AND OR CHISEL ANY CRACKS OVER 0.5 MM TO THE REQUIRED DEPTH OF 40 MM X 25 MM (1.5" X 1")
2. PACK WITH KRYSTOL REPAIR GROUT AT A RATE OF APPROPRIATELY 2.5 KG PER LINEAL METER (1.6 LB PER LINEAL FOOT)
3. APPLY KRYSTOL T1 AT A RATE OF 1.2 KG PER M² (2.2 LBS PER YD²)

NOTES:

1. INSTALLATION TO BE COMPLETED IN ACCORDANCE WITH MANUFACTURER'S SPECIFICATIONS.
2. DO NOT SCALE DRAWING.
3. THIS DRAWING IS INTENDED FOR USE BY ARCHITECTS, ENGINEERS, CONTRACTORS, CONSULTANTS AND DESIGN PROFESSIONALS FOR PLANNING PURPOSES ONLY. THIS DRAWING MAY NOT BE USED FOR CONSTRUCTION.
4. ALL INFORMATION CONTAINED HEREIN WAS CURRENT AT THE TIME OF DEVELOPMENT BUT MUST BE REVIEWED AND APPROVED BY THE PRODUCT MANUFACTURER TO BE CONSIDERED ACCURATE.
5. CONTRACTOR'S NOTE: FOR PRODUCT AND COMPANY INFORMATION VISIT www.CADdetails.com/info AND ENTER REFERENCE NUMBER 5104-062

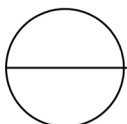

KRYSTOL T1 SURFACE APPLIED CRYSTALLINE WATERPROOFING

HORIZONTAL SURFACES