

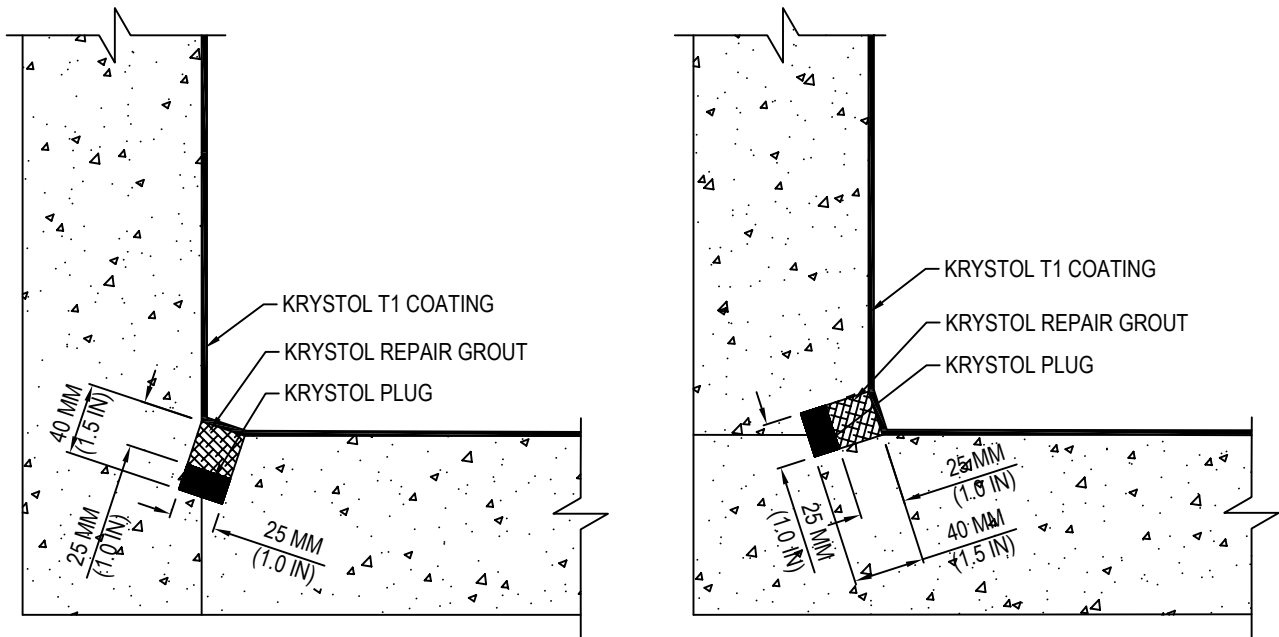

KRYTON INTERNATIONAL INC.
 1645 EAST KENT AVE.
 VANCOUVER, BC V5P 2S8
 TOLL FREE: 1-800-267-8280
 PHONE: (604) 324-8280
 FAX: (604) 324-8899
 www.kryton.com



WALL TO SLAB JOINT REPAIR

MANUFACTURER'S NOTES:

CHISEL TO CREATE A CHASE ALONG THE ENTIRE LENGTH OF THE LEAKING CRACK OR JOINT TO THE REQUIRED 25 MM X 40 MM (1" X 1.5")

1. APPLY KRYSTOL PLUG TO PREPARED CHASE TO STOP FLOWING WATER.
2. TIGHTLY PACK REMAINING CHASE WITH KRYSTOL REPAIR GROUT AT A RATE OF APPROXIMATELY 1.6 KG PER LINEAL METER (1 LB. PER LINEAL FOOT).
3. WATERPROOF ENTIRE WALL OR SLAB WITH KRYSTOL T1 AT A RATE OF 1.2 KG/M²

NOTES:

1. INSTALLATION TO BE COMPLETED IN ACCORDANCE WITH MANUFACTURER'S SPECIFICATIONS.
2. DO NOT SCALE DRAWING.
3. THIS DRAWING IS INTENDED FOR USE BY ARCHITECTS, ENGINEERS, CONTRACTORS, CONSULTANTS AND DESIGN PROFESSIONALS FOR PLANNING PURPOSES ONLY. THIS DRAWING MAY NOT BE USED FOR CONSTRUCTION.
4. ALL INFORMATION CONTAINED HEREIN WAS CURRENT AT THE TIME OF DEVELOPMENT BUT MUST BE REVIEWED AND APPROVED BY THE PRODUCT MANUFACTURER TO BE CONSIDERED ACCURATE.
5. CONTRACTOR'S NOTE: FOR PRODUCT AND COMPANY INFORMATION VISIT www.CADdetails.com/info AND ENTER REFERENCE NUMBER 5104-035

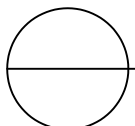

KRYSTOL LEAK REPAIR SYSTEM

WALL TO SLAB – LEAK REPAIR